

Specialist Resource Provision Public Consultation

14 Mar 2018



The
JUDD
School



Our Values

- ▶ Recent assemblies on Personal Identity, The Equality Act and the current consultation process
 - ▶ Educating students and setting high expectations of the treatment of all people irrespective of their status under the protected characteristics
- ▶ Culture of mutual respect
- ▶ An inclusive admissions policy
 - ▶ Greater focus on West Kent children
 - ▶ Children in Care with a 'grammar' assessment given first priority in oversubscription criteria
 - ▶ 5 further places prioritised for children in receipt of Free School Meals
- ▶ Education through PSHE

An Inclusive Approach to Student Support

Student support works for all Judd students, not just those in the proposed SRP. It includes:

- ▶ Supporting a range of Specific Learning Difficulties
- ▶ Support in class
- ▶ Subject specific support outside lessons
- ▶ Support for issues of mental health, managing anxiety and stressful situations
- ▶ Access Arrangements for learning
- ▶ School Counsellor
- ▶ Bereavement support
- ▶ Helping students improve behaviour
- ▶ Supporting personal organisation
- ▶ Working with families and outside agencies

Why does KCC wish to open a Specialist Resource Provision at The Judd School

- ▶ KCC would like students to be supported in mainstream schools
- ▶ giving access to high quality subject specialist teachers and access to specialist teaching facilities
- ▶ to make use of the knowledge and expertise of the school to the full and accommodate local West Kent students with ASD in a caring, nurturing environment
- ▶ to respond to the desire from parents to develop mainstream provision rather than special schools
- ▶ acknowledging the school has already invested in developing its staff expertise in ASD

Autism

- ▶ Autism is a lifelong developmental disability that affects how people perceive the world and interact with others.
- ▶ Autistic people see, hear and feel the world differently to other people. If you are autistic, you are autistic for life; autism is not an illness or disease and cannot be 'cured'. Often people feel being autistic is a fundamental aspect of their identity.
- ▶ Autism is a spectrum condition. All autistic people share certain difficulties, but being autistic will affect them in different ways. All people on the autism spectrum learn and develop. With the right sort of support, all can be helped to live a more fulfilling life of their own choosing.

The SRP would support students with an EHCP with a diagnosis of ASD and a grammar assessment in the 11+.

Accommodation

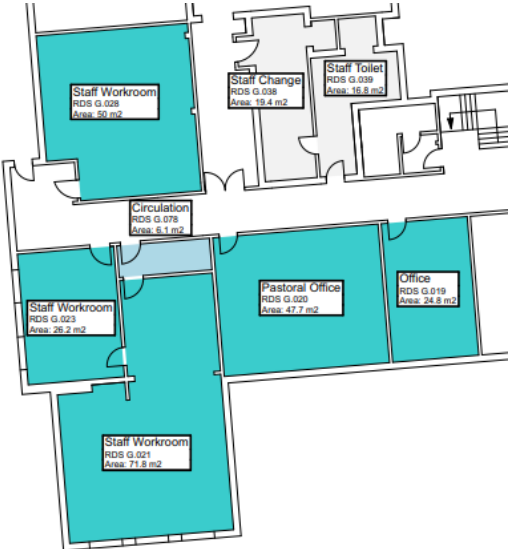

Current Staff Area

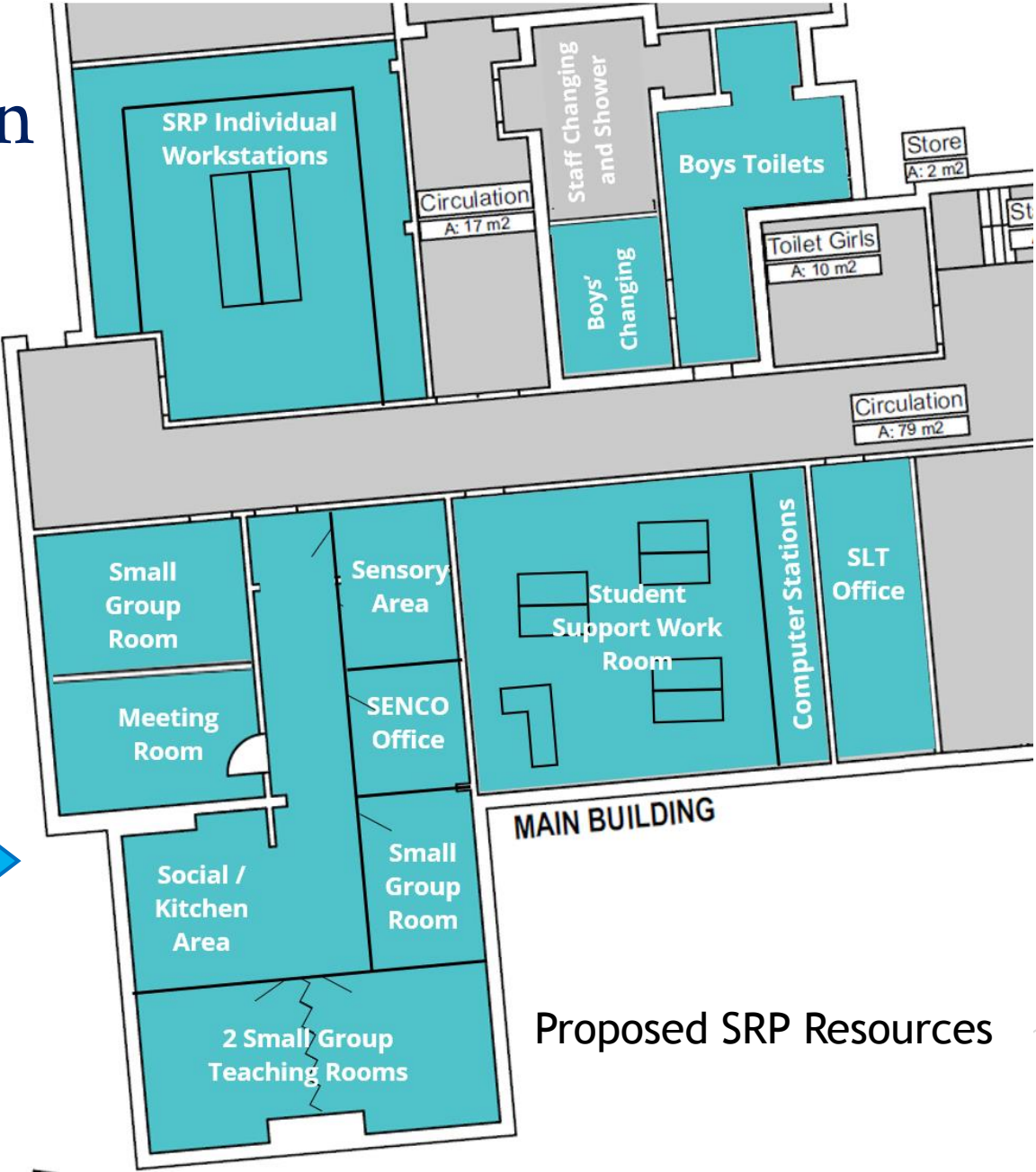
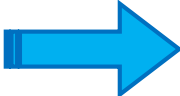

Proposed SRP Resources

Benefits of the SRP to all...

To members of the SRP	To all current / future students
High level of individual support in and out of lessons	Teachers receive additional training to ensure lessons adapted to meet the needs of students with ASD, benefit to all others with similar traits or diagnosed condition.
Highly qualified teachers and high quality subject specific facilities	Larger scale Student Support Team gives greater flexibility to react to individual support needs of all students
Supportive environment and culture of learning and ambition	Better facilities for Student Support Area, improved access for all students
Extensive, dedicated facilities for Student Support	Ability to attract specialist LSAs to support all students' learning
Quiet, personal work area to assist with organisation and private study	

Please ask questions and share your comments with us...

THE JUDD SCHOOL EDUCATION CONSULTATION RESPONSE FORM

Please complete this response form by **no later than midnight on 28 March 2018** and return it by:

- handing your response form into The Judd School reception.
- emailing: school.consultations@kent.gov.uk
- posting the response form to Jared Nehra, KCC Area Education Officer (West Kent), West Kent Area Office, Sessions House, County Hall, Maidstone, Kent ME14 1XQ.

Do you agree with the proposal to establish a new Specialist Resource Provision (SRP) for up to 20 students with ASD at The Judd School from September 2019?

Yes No Undecided

Which of the following best describes you?

Parent/Carer / Member of Staff / Governor / Pupil

OR - Other interested party (please state interest).

Name Address.....

.....

Comments